

**PERFORMANCE**

Model	Maximum flow rate			Maximum head	
	l/min	cu.m/hr	gall/min	metres	feet
CM100_175	4166	250	916	37	121

**DIMENSIONS IN MM (APPROX.)**

**WEIGHT: 62kg**

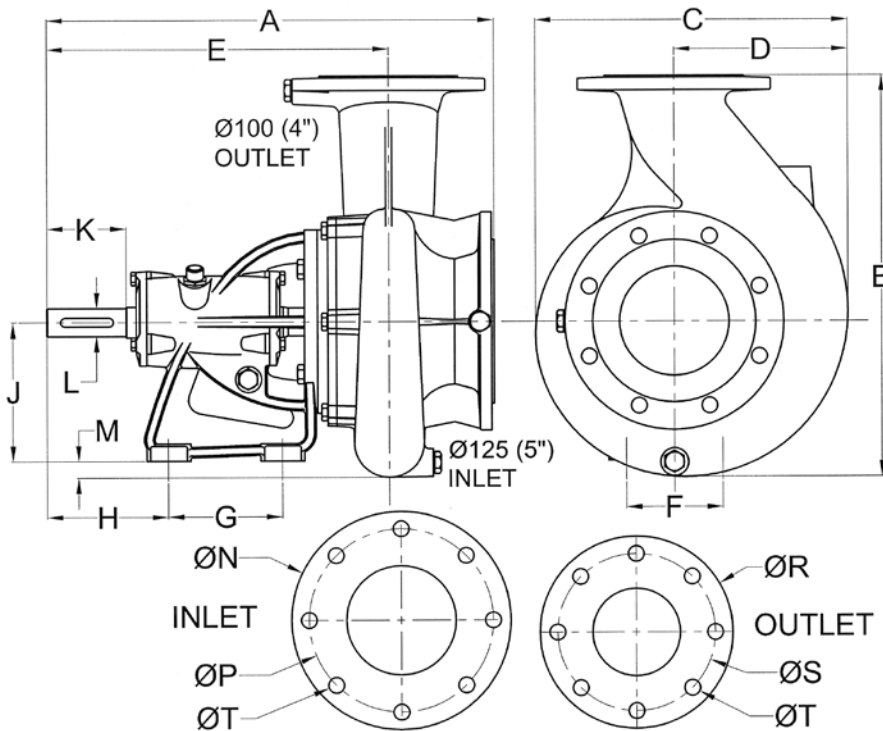

A	B	C	D	E	F	G	H	J	K	L	M	N	P	R	S	T
510	459	355	198	364	110	130	138	160	90	Ø32	19	250	210	220	180	Ø18

**MATERIALS OF CONSTRUCTION**

Pump casing	bronze
Impeller	bronze
Shaft	stainless steel AISI316
Bearing housing	cast iron
Pump head bolts	stainless steel
O-ring static seal	nitrile rubber

Pump performance and specification are subject to alteration without notice

**AVAILABLE CLUTCHES** (ask for a data sheet)

Clutch Type	Pulley Pitch Dia	Pulley Belt Section	No of Belts	FP Code
MANUAL	DM35 - SPECIAL BEARING HOUSING WITH BUILT IN CLUTCH			FP-94-8001011

**FP PUMPS**

**CM100-175**

**100mm (4") BRONZE NON-SELF-PRIMING CENTRIFUGAL PUMP**



- \* corrosion-resistant bronze body & impeller, with stainless steel shaft
- \* available with clockwise or anti-clockwise rotation – please specify
- \* carbon-ceramic mechanical shaft seal

**BRONZE PUMPS**

for

**SEAWATER**

Xylem Water Solutions UK Ltd  
 Bingley Road  
 Hoddesdon  
 Hertfordshire • EN11 0BU • UK

Tel: +44 (0)1462 480380  
 Fax: +44 (0)1462 482422  
 mail@clegghorn.co.uk  
 www.jabscoshop.com

